

# Further education and skills: July 2025 underlying data

## Metadata specification

### Description

This document describes the additional supporting files that accompany the 'Further education and skills: July 2025' accredited official statistics publication. This data is released under the terms of the [Open Government License](#). It is provided to allow users to interrogate the data themselves.

The underlying data files cover England and include Further Education and Skills learner participation/achievements and aim enrolment/achievement figures. Some tables also include further breakdowns; by provision type (e.g. education and training, tailored learning, or apprenticeships), by learner characteristics (e.g. age, sex, ethnicity group) or subject characteristics (e.g. sector subject area, level, learning aim).

The [Further education and skills statistics: methodology](#) document published alongside the main release should be referenced alongside this data. It provides information on the data sources, their coverage and quality as well as explaining methodology used in producing the data.

### Annex A - Field Listing

### Annex B – How to use excel to connect to larger underlying files for your analysis

### The underlying data consists of the following files:

- Underlying data - FE and skills (FES) learner participation
- Underlying data - FE and skills (FES) learner participation, under 19s (in development)
- Underlying data - FE and skills (FES) aims enrolments
- Underlying data - FE and skills (FES) aims enrolments 2023/24 re-cast
- Underlying data - FE and skills (FES) aims achievements
- Underlying data - FE and skills (FES) aims achievements 2023/24 re-cast
- Underlying data - FE and skills (FES) demographics
- Underlying data – Free Courses for Jobs Starts and Achievements on Individual Courses
- Underlying data – advanced learner loans applications - top 10 qualifications
- Education and Training Achievement Rates - Transparency Redactions
- FE and skills (FES) learner achievements (excluding Community Learning and non-regulated Multiply aims)
- FE and skills (FES) learner achievements (excluding Community Learning and non-regulated Multiply aims) by local authority
- Free Courses for Jobs course list starts by provider and academic year
- FE and skills (FES) provider participation by provision type and learner characteristic

File and description	Geographic levels	Time period
<b>Underlying data - FE and skills (FES) learner participation</b> <i>fes-underlying-data-learner-participation-202425-q3.csv</i>  <b>year:</b> Academic year <b>snapshot:</b> Snapshot <b>ukprn:</b> Provider UKPRN <b>provider_name:</b> Provider name <b>provider_type:</b> Provider type <b>learner_home_region_code:</b> Learner region code (based on home postcode) <b>learner_home_region:</b> Learner region description (based on home postcode) <b>learner_home_pcon_code:</b> Learner parliamentary constituency code (based on home postcode) <b>learner_home_pcon:</b> Learner parliamentary constituency description (based on home postcode) <b>learner_home_la_code:</b> Learner local authority code (based on home postcode) <b>learner_home_la:</b> Learner local authority description (based on home postcode) <b>learner_home_lad_code:</b> Learner local authority district code (based on home postcode) <b>learner_home_lad:</b> Learner local authority district description (based on home postcode) <b>learner_home_devolved_administration_code:</b> Learner English devolved area code (based on home postcode) <b>learner_home_devolved_administration:</b> Learner English devolved area description (based on home postcode) <b>age_detailed:</b> Detailed age group  <b>fes_total:</b> All age Further education and skills learner participation (comprises Adult (19+) Further education and skills, and under 19 apprenticeships) <b>fes_19p:</b> Adult (19+) Further education and skills learner participation <b>e_and_t_19p:</b> Adult (19+) Education and training learner participation <b>apps_total:</b> All age Apprenticeship learner participation <b>apps_19p:</b> Adult (19+) Apprenticeship learner participation <b>tailored_learning_total:</b> Tailored learning total learner participation	National, region, local authority, local authority district, parliamentary constituency, English devolved administration	2019/20 (full year)  2020/21 (full year)  2021/22 (full year)  2022/23 (full year)  2023/24 (full year)  2024/25 (Aug-Apr Reported to date)

File and description	Geographic levels	Time Period
<p><b>Underlying data – FE and skills (FES) learner participation, under 19s (in development)</b></p> <p><i>fes-underlying-data-learner-participation-under-19-202425-q3.csv</i></p> <p><b>year:</b> Academic year  <b>snapshot:</b> Snapshot  <b>ukprn:</b> Provider UKPRN  <b>provider_name:</b> Provider name  <b>provider_type:</b> Provider type</p> <p><b>fes_total_u19:</b> Under 19 further education and skills learner participation (including apprenticeships)  <b>e_and_t_u19:</b> Under 19 education and training learner participation  <b>apps_u19:</b> Under 19 apprenticeship learner participation</p>	National	<p>2021/22 (full year)</p> <p>2022/23 (full year)</p> <p>2023/24 (full year)</p> <p>2024/25 (Aug-Apr Reported to date)</p>

<p><b>Underlying data - FE and skills (FES) aims enrolments</b>  <i>fes-underlying-data-aims-enrolments-202425-q3.csv</i></p> <p><b>year:</b> Academic year  <b>snapshot:</b> Snapshot  <b>ukprn:</b> Provider UKPRN  <b>provider_name:</b> Provider name  <b>provider_type:</b> Provider type  <b>detailed_provider_type:</b> Detailed provider type  <b>delivery_region_code:</b> Learner region code (based on delivery postcode)  <b>delivery_region:</b> Learner region description (based on delivery postcode)  <b>delivery_pcon_code:</b> Learner parliamentary constituency code (based on delivery postcode)  <b>delivery_pcon:</b> Learner parliamentary constituency description (based on delivery postcode)  <b>delivery_la_code:</b> Learner local authority code (based on delivery postcode)  <b>delivery_la:</b> Learner local authority description (based on delivery postcode)  <b>delivery_lad_code:</b> Learner local authority district code (based on delivery postcode)  <b>delivery_lad:</b> Learner local authority district description (based on delivery postcode)  <b>delivery_devolved_administration_code:</b> Learner English devolved area code (based on delivery postcode)  <b>delivery_devolved_administration:</b> Learner English devolved area description (based on delivery postcode)  <b>learner_home_region_code:</b> Learner region code (based on home postcode)  <b>learner_home_region:</b> Learner region description (based on home postcode)  <b>learner_home_pcon_code:</b> Learner parliamentary constituency code (based on home postcode)  <b>learner_home_pcon:</b> Learner parliamentary constituency description (based on home postcode)  <b>learner_home_la_code:</b> Learner local authority code (based on home postcode)  <b>learner_home_la:</b> Learner local authority description (based on home postcode)  <b>learner_home_lad_code:</b> Learner local authority district code (based on home postcode)  <b>learner_home_lad:</b> Learner local authority district description (based on home postcode)  <b>learner_home_devolved_administration_code:</b> Learner English devolved area code (based on home postcode)  <b>learner_home_devolved_administration:</b> Learner English devolved area description (based on home postcode)</p>	<p>National, region, local authority, local authority district, parliamentary constituency, English devolved administration</p>	<p>2024/25 (Aug-Apr Reported to date)</p>
---	---	---

<p><b>age_academic_summary_with_unknowns:</b> summary age group (age as at 31 August of the academic year)</p> <p><b>age_academic_detailed:</b> detailed age group (age as at 31 August of the academic year)</p> <p><b>age_start_detailed:</b> detailed age group (age at the start of the programme)</p> <p><b>notional_nvq_level:</b> level of the learning aim</p> <p><b>stem:</b> STEM flag</p> <p><b>ssa_tier_1_code:</b> Sector subject area Tier 1 code</p> <p><b>ssa_tier_1:</b> Sector subject area Tier 1 description</p> <p><b>ssa_tier_2_code:</b> Sector subject area Tier 2 code</p> <p><b>ssa_tier_2:</b> Sector subject area Tier 2 description</p> <p><b>learning_aim_reference:</b> Learning aim reference number</p> <p><b>learning_aim_title:</b> Learning aim title</p> <p><b>learning_aim_type:</b> Learning aim type</p> <p><b>essential_skills_qualification_type:</b> Essential skills qualification type</p> <p><b>awarding_organisation_description:</b> Awarding organisation description</p> <p><b>htq_status:</b> Higher technical qualification status</p> <p><b>fes_total_aim_enrolments:</b> All age Further education and skills aim enrolments</p> <p><b>fes_19p_aim_enrolments:</b> Adult (19+) Further education and skills aim enrolments</p> <p><b>et_total_aim_enrolments:</b> All age Education and training aim enrolments</p> <p><b>et_19p_aim_enrolments:</b> Adult (19+) Education and training aim enrolments</p> <p><b>apps_total_funded_aim_enrolments:</b> All age Apprenticeship aim enrolments</p> <p><b>apps_19p_funded_aim_enrolments:</b> Adult (19+) Apprenticeship aim enrolments</p> <p><b>tailored_learning_aim_enrolments:</b> Tailored learning aim enrolments</p> <p><b>loan_aim_enrolments:</b> Loan enrolments</p> <p><b>multiply_aim_enrolments:</b> Adult (19+) enrolments funded through the Multiply programme</p> <p>Please note:</p> <ul style="list-style-type: none"> <li>• academic age (as at 31 August) is for use with FES, ET and TL enrolments. Age at start of programme is for use with apprenticeship enrolments.</li> <li>• The HTQ data here only includes learners recorded via the ILR. There are additional HTQ learners recorded via HESA data</li> <li>• Essential skills qualification type is primarily the 'Skills for life type description' recorded on the Learning Aim Reference Service (LARS) with additional types included for non-regulated essential skills aims not present on LARS.</li> </ul>		
---	--	--

<p><b>Underlying data - FE and skills (FES) aims enrolments 2023/24 re-cast</b></p> <p><i>fes-underlying-data-aims-enrolments-202324-q4.csv</i></p> <p>This is based on SN14 Individualised Learner Record data return and contains finalised full year data for the 2023/24 academic year as originally published in November 2024. The education and training figures have been recast to amalgamate what were previously separately reported education and training and community learning figures as a new education and training breakdown.</p> <p><b>year:</b> Academic year  <b>snapshot:</b> Snapshot  <b>ukprn:</b> Provider UKPRN  <b>provider_name:</b> Provider name  <b>provider_type:</b> Provider type  <b>delivery_region_code:</b> Learner region code (based on delivery postcode)  <b>delivery_region:</b> Learner region description (based on delivery postcode)  <b>delivery_pcon_code:</b> Learner parliamentary constituency code (based on delivery postcode)  <b>delivery_pcon:</b> Learner parliamentary constituency description (based on delivery postcode)  <b>delivery_la_code:</b> Learner local authority code (based on delivery postcode)  <b>delivery_la:</b> Learner local authority description (based on delivery postcode)  <b>delivery_lad_code:</b> Learner local authority district code (based on delivery postcode)  <b>delivery_lad:</b> Learner local authority district description (based on delivery postcode)  <b>delivery_devolved_administration_code:</b> Learner English devolved area code (based on delivery postcode)  <b>delivery_devolved_administration:</b> Learner English devolved area description (based on delivery postcode)  <b>learner_home_region_code:</b> Learner region code (based on home postcode)  <b>learner_home_region:</b> Learner region description (based on home postcode)  <b>learner_home_pcon_code:</b> Learner parliamentary constituency code (based on home postcode)  <b>learner_home_pcon:</b> Learner parliamentary constituency description (based on home postcode)  <b>learner_home_la_code:</b> Learner local authority code (based on home postcode)  <b>learner_home_la:</b> Learner local authority description (based on home postcode)  <b>learner_home_lad_code:</b> Learner local authority district code (based on home postcode)</p>	<p>National, region, local authority, local authority district, parliamentary constituency, English devolved administration</p>	<p>2023/24 (full year)</p>
---	---	----------------------------

<p><b>learner_home_lad:</b> Learner local authority district description (based on home postcode)</p> <p><b>learner_home_devolved_administration_code:</b> Learner English devolved area code (based on home postcode)</p> <p><b>learner_home_devolved_administration:</b> Learner English devolved area description (based on home postcode)</p> <p><b>age_academic_summary_with_unknowns:</b> summary age group (age as at 31 August of the academic year)</p> <p><b>age_academic_detailed:</b> detailed age group (age as at 31 August of the academic year)</p> <p><b>age_start_detailed:</b> detailed age group (age at the start of the programme)</p> <p><b>notional_nvq_level:</b> level of the learning aim</p> <p><b>stem:</b> STEM flag</p> <p><b>ssa_tier_1_code:</b> Sector subject area Tier 1 code</p> <p><b>ssa_tier_1:</b> Sector subject area Tier 1 description</p> <p><b>ssa_tier_2_code:</b> Sector subject area Tier 2 code</p> <p><b>ssa_tier_2:</b> Sector subject area Tier 2 description</p> <p><b>learning_aim_reference:</b> Learning aim reference number</p> <p><b>learning_aim_title:</b> Learning aim title</p> <p><b>learning_aim_type:</b> Learning aim type</p> <p><b>essential_skills_qualification_type:</b> Essential skills qualification type</p> <p><b>awarding_organisation_description:</b> Awarding organisation description</p> <p><b>htq_status:</b> Higher technical qualification status</p> <p><b>fes_total_aim_enrolments:</b> All age Further education and skills aim enrolments</p> <p><b>fes_19p_aim_enrolments:</b> Adult (19+) Further education and skills aim enrolments</p> <p><b>et_total_aim_enrolments:</b> All age Education and training aim enrolments</p> <p><b>et_19p_aim_enrolments:</b> Adult (19+) Education and training aim enrolments</p> <p><b>apps_total_funded_aim_enrolments:</b> All age Apprenticeship aim enrolments</p> <p><b>apps_19p_funded_aim_enrolments:</b> Adult (19+) Apprenticeship aim enrolments</p> <p><b>community_learning_aim_enrolments:</b> Community learning aim enrolments</p> <p><b>loan_aim_enrolments:</b> Loan enrolments</p> <p><b>multiply_aim_enrolments:</b> Adult (19+) enrolments funded through the Multiply programme</p> <p>Please note:</p>		
---	--	--

<ul style="list-style-type: none"> <li>• academic age (as at 31 August) is for use with FES, ET and CL enrolments. Age at start of programme is for use with apprenticeship enrolments.</li> <li>• The HTQ data here only includes learners recorded via the ILR. There are additional HTQ learners recorded via HESA data</li> <li>• Essential skills qualification type is primarily the 'Skills for life type description' recorded on the Learning Aim Reference Service (LARS) with additional types included for non-regulated essential skills aims not present on LARS.</li> </ul>		
--	--	--



<p><b>Underlying data - FE and skills (FES) aims achievements</b>  <i>fes-underlying-data-aims-achievements-202425-q3.csv</i></p> <p><b>year:</b> Academic year  <b>snapshot:</b> Snapshot  <b>ukprn:</b> Provider UKPRN  <b>provider_name:</b> Provider name  <b>provider_type:</b> Provider type  <b>detailed_provider_type:</b> Detailed provider type  <b>delivery_region_code:</b> Learner region code (based on delivery postcode)  <b>delivery_region:</b> Learner region description (based on delivery postcode)  <b>delivery_pcon_code:</b> Learner parliamentary constituency code (based on delivery postcode)  <b>delivery_pcon:</b> Learner parliamentary constituency description (based on delivery postcode)  <b>delivery_la_code:</b> Learner local authority code (based on delivery postcode)  <b>delivery_la:</b> Learner local authority description (based on delivery postcode)  <b>delivery_lad_code:</b> Learner local authority district code (based on delivery postcode)  <b>delivery_lad:</b> Learner local authority district description (based on delivery postcode)  <b>delivery_devolved_administration_code:</b> Learner English devolved area code (based on delivery postcode)  <b>delivery_devolved_administration:</b> Learner English devolved area description (based on delivery postcode)  <b>learner_home_region_code:</b> Learner region code (based on home postcode)  <b>learner_home_region:</b> Learner region description (based on home postcode)  <b>learner_home_pcon_code:</b> Learner parliamentary constituency code (based on home postcode)  <b>learner_home_pcon:</b> Learner parliamentary constituency description (based on home postcode)  <b>learner_home_la_code:</b> Learner local authority code (based on home postcode)  <b>learner_home_la:</b> Learner local authority description (based on home postcode)  <b>learner_home_lad_code:</b> Learner local authority district code (based on home postcode)  <b>learner_home_lad:</b> Learner local authority district description (based on home postcode)  <b>learner_home_devolved_administration_code:</b> Learner English devolved area code (based on home postcode)  <b>learner_home_devolved_administration:</b> Learner English devolved area description (based on home postcode)</p>	<p>National, region, local authority, local authority district, parliamentary constituency, English devolved administration</p>	<p>2024/25 (Aug-Apr Reported to date)</p>
---	---	---

<p><b>age_youth_adult:</b> age 19+ or under 19 (age as at 31 August of the academic year)</p> <p><b>age_summary_with_unknowns:</b> summary age group (age as at 31 August of the academic year)</p> <p><b>age_detailed:</b> detailed age group (age as at 31 August of the academic year)</p> <p><b>notional_nvq_level:</b> level of the learning aim</p> <p><b>stem:</b> STEM flag</p> <p><b>ssa_tier_1_code:</b> Sector subject area Tier 1 code</p> <p><b>ssa_tier_1:</b> Sector subject area Tier 1 description</p> <p><b>ssa_tier_2_code:</b> Sector subject area Tier 2 code</p> <p><b>ssa_tier_2:</b> Sector subject area Tier 2 description</p> <p><b>learning_aim_reference:</b> Learning aim reference number</p> <p><b>learning_aim_title:</b> Learning aim title</p> <p><b>learning_aim_type:</b> Learning aim type</p> <p><b>essential_skills_qualification_type:</b> Essential skills qualification type</p> <p><b>awarding_organisation_description:</b> Awarding organisation description</p> <p><b>htq_status:</b> Higher technical qualification status</p> <p><b>fes_total_aim_achievements:</b> All age Further education and skills aim achievements</p> <p><b>fes_19p_aim_achievements:</b> Adult (19+) Further education and skills aim achievements</p> <p><b>et_19p_aim_achievements:</b> Adult (19+) Education and training aim achievements</p> <p><b>apps_total_funded_aim_achievements:</b> All age Apprenticeship aim achievements</p> <p><b>apps_total_funded_19p_aim_achievements:</b> Adult (19+) Apprenticeship aim achievements</p> <p><b>tailored_learning_aim_achievements:</b> Tailored learning aim achievements</p> <p><b>loan_aim_achievements:</b> Loan achievements</p> <p><b>multiply_aim_achievements:</b> Adult (19+) enrolments funded through the Multiply programme</p> <p>Please note:</p> <ul style="list-style-type: none"> <li>• HTQ data here only includes learners recorded via the ILR. There are additional HTQ learners recorded via HESA data.</li> <li>• Essential skills qualification type is primarily the 'Skills for life type description' recorded on the Learning Aim Reference Service (LARS) with additional types included for non-regulated essential skills aims not present on LARS.</li> </ul>		
--	--	--

<p><b>Underlying data - FE and skills (FES) aims achievements 2023/24 re-cast</b></p> <p><i>fes-underlying-data-aims-achievements-202324-q4.csv</i></p> <p>This is based on SN14 Individualised Learner Record data return and contains finalised full year data for the 2023/24 academic year as originally published in November 2024. The education and training figures have been recast to amalgamate what were previously separately reported education and training and community learning figures as a new education and training breakdown.</p> <p><b>year:</b> Academic year  <b>snapshot:</b> Snapshot  <b>ukprn:</b> Provider UKPRN  <b>provider_name:</b> Provider name  <b>provider_type:</b> Provider type  <b>delivery_region_code:</b> Learner region code (based on delivery postcode)  <b>delivery_region:</b> Learner region description (based on delivery postcode)  <b>delivery_pcon_code:</b> Learner parliamentary constituency code (based on delivery postcode)  <b>delivery_pcon:</b> Learner parliamentary constituency description (based on delivery postcode)  <b>delivery_la_code:</b> Learner local authority code (based on delivery postcode)  <b>delivery_la:</b> Learner local authority description (based on delivery postcode)  <b>delivery_lad_code:</b> Learner local authority district code (based on delivery postcode)  <b>delivery_lad:</b> Learner local authority district description (based on delivery postcode)  <b>delivery_devolved_administration_code:</b> Learner English devolved area code (based on delivery postcode)  <b>delivery_devolved_administration:</b> Learner English devolved area description (based on delivery postcode)  <b>learner_home_region_code:</b> Learner region code (based on home postcode)  <b>learner_home_region:</b> Learner region description (based on home postcode)  <b>learner_home_pcon_code:</b> Learner parliamentary constituency code (based on home postcode)  <b>learner_home_pcon:</b> Learner parliamentary constituency description (based on home postcode)  <b>learner_home_la_code:</b> Learner local authority code (based on home postcode)  <b>learner_home_la:</b> Learner local authority description (based on home postcode)  <b>learner_home_lad_code:</b> Learner local authority district code (based on home postcode)</p>	<p>National, region, local authority, local authority district, parliamentary constituency, English devolved administration</p>	<p>2023/24 (full year)</p>
---	---	----------------------------

<p><b>learner_home_lad:</b> Learner local authority district description (based on home postcode)</p> <p><b>learner_home_devolved_administration_code:</b> Learner English devolved area code (based on home postcode)</p> <p><b>learner_home_devolved_administration:</b> Learner English devolved area description (based on home postcode)</p> <p><b>age_youth_adult:</b> age 19+ or under 19 (age as at 31 August of the academic year)</p> <p><b>age_summary_with_unknowns:</b> summary age group (age as at 31 August of the academic year)</p> <p><b>age_detailed:</b> detailed age group (age as at 31 August of the academic year)</p> <p><b>notional_nvq_level:</b> level of the learning aim</p> <p><b>stem:</b> STEM flag</p> <p><b>ssa_tier_1_code:</b> Sector subject area Tier 1 code</p> <p><b>ssa_tier_1:</b> Sector subject area Tier 1 description</p> <p><b>ssa_tier_2_code:</b> Sector subject area Tier 2 code</p> <p><b>ssa_tier_2:</b> Sector subject area Tier 2 description</p> <p><b>learning_aim_reference:</b> Learning aim reference number</p> <p><b>learning_aim_title:</b> Learning aim title</p> <p><b>learning_aim_type:</b> Learning aim type</p> <p><b>essential_skills_qualification_type:</b> Essential skills qualification type</p> <p><b>awarding_organisation_description:</b> Awarding organisation description</p> <p><b>htq_status:</b> Higher technical qualification status</p> <p><b>fes_total_aim_achievements:</b> All age Further education and skills aim achievements</p> <p><b>fes_19p_aim_achievements:</b> Adult (19+) Further education and skills aim achievements</p> <p><b>et_19p_aim_achievements:</b> Adult (19+) Education and training aim achievements</p> <p><b>apps_total_funded_aim_achievements:</b> All age Apprenticeship aim achievements</p> <p><b>apps_total_funded_19p_aim_achievements:</b> Adult (19+) Apprenticeship aim achievements</p> <p><b>community_learning_aim_achievements:</b> Community learning aim achievements</p> <p><b>loans_aim_achievements:</b> Loan achievements</p> <p><b>multiply_aim_achievements:</b> Adult (19+) enrolments funded through the Multiply programme</p> <p>Please note:</p> <ul style="list-style-type: none"> <li>The HTQ data here only includes learners recorded via the ILR. There are additional HTQ learners recorded via HESA data.</li> </ul>		
--	--	--

<ul style="list-style-type: none"> <li>• Essential skills qualification type is primarily the 'Skills for life type description' recorded on the Learning Aim Reference Service (LARS) with additional types included for non-regulated essential skills aims not present on LARS.</li> </ul>		
---	--	--

<p><b>Underlying data for FE and Skills (FES) demographics</b></p> <p><i>fes-underlying-data- demographics-202425-q3.csv</i></p> <p><i>This csv is rounded and contains pre-calculated totals. Please be aware when using this tool to derive further breakdowns.</i></p> <p><b>year:</b> Academic year</p> <p><b>snapshot:</b> Snapshot</p> <p><b>provision_type:</b></p> <ul style="list-style-type: none"> <li>Further Education and Skills: Further education and skills participation (All Age)</li> <li>Tailored Learning: Tailored learning participation</li> <li>Education and Training: Education and training participation (Adult (19+))</li> <li>Apprenticeships: Apprenticeship participation (All Age)</li> </ul> <p><b>age_summary_with_unknowns:</b> Age group</p> <p><b>age_youth_adult:</b> Age group (19+ or under 19)</p> <p><b>sex:</b> Sex</p> <p><b>l1dd:</b> LLDD status</p> <p><b>ethnicity_major:</b> Ethnicity group</p> <p><b>ethnicity_minor:</b> Ethnicity detail</p> <p><b>participation:</b> Learner participation</p> <p><i>Please note: to get adult (19+) FES participation, or adult (19+) apprenticeship participation figures, the age filter must be used.</i></p>	National	<p>2019/20 (full year)</p> <p>2020/21 (full year)</p> <p>2021/22 (full year)</p> <p>2022/23 (full year)</p> <p>2023/24 (full year)</p> <p>2024/25 (Aug-Apr Reported to date)</p>
--	----------	--

<p><b>Underlying data – Free Courses for Jobs Starts and Achievements on Individual Courses</b></p> <p><i>underlying-data-fes-free-courses-for-jobs-qualifications-2425-q3.csv</i></p> <p><b>qualification_reference_number:</b> Qualification reference number</p> <p><b>qualification_title:</b> Title of the qualification</p> <p><b>qualification_type:</b> Type of qualification</p> <p><b>course_length:</b> Indicator of whether the qualification is a short course</p> <p><b>guided_learning_hours:</b> guided learning hours associated with the course</p> <p><b>ssa_t1:</b> Sector subject area tier 1 description</p> <p><b>ssa_t2:</b> Sector subject area tier 2 description</p> <p><b>free_courses_for_jobs_valid_from:</b> Free courses for jobs funding approval start date</p> <p><b>free_courses_for_jobs_valid_to:</b> Free courses for jobs funding approval end date</p> <p><b>fcfj_enrolments:</b> Free courses for jobs total starts under the offer (April 21 to October 24)</p> <p><b>fcfj_achievements:</b> Free courses for jobs total achievements under the offer (April 21 to October 24)</p>	National	April 2021 to April 2025
---	----------	--------------------------

<b>Free Courses for Jobs course list starts by provider and academic year</b> <i>fes-subject-courses-for-jobs_provider-2425-q3.csv</i>  <b>academic_year:</b> Academic year <b>ukprn:</b> Provider UKPRN <b>provider_name:</b> Provider name <b>provider_type:</b> Provider type <b>free_courses_for_jobs_enrolments:</b> Total starts by any adults on courses from the list valid for free courses for jobs	National	April 2021 to April 2025
--	----------	--------------------------



<p><b>FE and skills (FES) provider participation by provision type and learner characteristic</b></p> <p><i>national-provider-summary-participation-2425-q3.csv</i></p> <p><b>time_period:</b> Academic year</p> <p><b>provider_name:</b> Provider name</p> <p><b>ukprn:</b> Provider UKPRN</p> <p><b>provider_type:</b> Provider type</p> <p><b>age_youth_adult:</b> academic age under 19 or 19+</p> <p><b>characteristic:</b> Characteristic of learners (e.g. sex, ethnicity, LLDD, Deprivation quintile)</p> <p><b>apprenticeships:</b> Number of learners participating in apprenticeships</p> <p><b>education_and_training:</b> Number of learners participating in education and training</p> <p><b>tailored_learning:</b> Number of learners participating in tailored learning</p> <p><b>community_learning:</b> Number of learners participating in community learning</p> <p><i>Note: The Under 19 data in this file is experimental, produced to support development of the FE Provider Performance Dashboard</i></p>	National	<p>2021/22 (full year)</p> <p>2022/23 (full year)</p> <p>2023/24 (full year)</p> <p>2024/25 (Aug-Apr Reported to date)</p>
--	----------	--

<p><b>Underlying data – advanced learner loans applications - top 10 qualifications</b></p> <p><i>adv-learner-loans-applications-top-10-qualifications-202324.csv</i></p> <p>This csv contains the top 10 advanced learner loans-funded learning aims per year, since the 2014/15 academic year.</p> <p><b>time_period:</b> academic year  <b>rank:</b> position of learning aim  <b>learning_aim_reference:</b> learning aim reference number  <b>learning_aim_title:</b> learning aim title  <b>awarding_organisation_description:</b> awarding organisation name  <b>notional_nvq_level:</b> level of the learning aim</p> <p><b>applications_received:</b> advanced learner loans applications received  <b>applications_approved:</b> advanced learner loans applications approved  <b>loan_amount_awarded:</b> loan amount awarded (£000s)</p>	National	2014/15 to 2023/24 (full academic years)
--	----------	---

<p><b>Education and Training Achievement Rates - Transparency Redactions</b></p> <p><i>Education and Training Achievement Rates - Transparency Redactions.pdf</i></p> <p>This csv contains redacted 2021/22 Education and Training achievement rates for those providers whose data has been redacted from the official provider level national achievement rate tables. Note there are no redactions for 2022/23 or 2023/24.</p> <p><b>provider_ukprn:</b> Provider UKPRN  <b>provider_name:</b> Provider name  <b>age_band:</b> Age group (16-18, 19+)  <b>sector_subject_area_t1:</b> Sector subject area Tier 1 description  <b>qualification_type:</b> Type of qualification  <b>qualification_level:</b> Level of qualification</p> <p><b>leavers:</b> Number of leavers  <b>completers:</b> Number of completers  <b>achievers:</b> Number of achievers  <b>retention_rate:</b> Retention rate  <b>pass_rate:</b> Pass rate  <b>achievement_rate:</b> Achievement rate</p>	National	2021/22 (full year)
---	----------	------------------------

<p><b>FE and skills (FES) learner achievements (excluding Community Learning and non-regulated Multiply aims)</b></p> <p><i>achievements_fes_excl_cl_outputs_national_202324.csv</i></p> <p><b>time_period:</b> Academic year</p> <p><b>time_identifier:</b> Time unit shown (i.e. academic or calendar year)</p> <p><b>geographic_level:</b> The geography shown (i.e. national or local authority)</p> <p><b>country_code:</b> Country code</p> <p><b>country_name:</b> Country name</p> <p><b>fes_excluding_cl_ach:</b> adult (19+) further and skills learner achievements (excluding Community Learning and non-regulated Multiply aims)</p> <p>Please note: This summary file contains a count of learners achieving any funded FE and skills learning aim, with the exception of community learning and non-regulated Multiply aims. The main FE and skills publication contains total FES learner achievements that include Community Learning and non-regulated Multiply provision.</p>	National	<p>2016/17 (full year)</p> <p>2017/18 (full year)</p> <p>2018/19 (full year)</p> <p>2019/20 (full year)</p> <p>2020/21 (full year)</p> <p>2021/22 (full year)</p> <p>2022/23 (full year)</p> <p>2023/24 (full year)</p>
--	----------	---

<p><b>FE and skills (FES) learner achievements (excluding Community Learning and non-regulated Multiply aims) by local authority</b></p> <p><i>achievements_fes_excl_cl_outputs_la_202324.csv</i></p> <p><b>time_period:</b> Academic year</p> <p><b>time_identifier:</b> Time unit shown (i.e. academic or calendar year)</p> <p><b>geographic_level:</b> The geography shown (i.e. national or local authority)</p> <p><b>country_code:</b> Country code</p> <p><b>country_name:</b> Country name</p> <p><b>learner_home_la_code:</b> Learner local authority code (based on home postcode)</p> <p><b>learner_home_la:</b> Learner local authority name (based on home postcode)</p> <p><b>fes_excluding_cl_ach:</b> adult (19+) further and skills learner achievements (excluding Community Learning and non-regulated Multiply aims)</p> <p>Please note: This summary file contains a count of learners achieving any funded FE and skills learning aim, with the exception of community learning and non-regulated Multiply aims. The main FE and skills publication contains total FES learner achievements that include Community Learning and non-regulated Multiply provision.</p>	Local authority	<p>2018/19 (full year)</p> <p>2019/20 (full year)</p> <p>2020/21 (full year)</p> <p>2021/22 (full year)</p> <p>2022/23 (full year)</p> <p>2023/24 (full year)</p>
--	-----------------	---

## Annex A – Field Listing

Further information about the fields in the underlying data files is given below:

Variable name	Variable description
Achievers (when used in achievement rate calculations)	A count of the number of learning aims that have been achieved.
Achievement	<p>A qualification or apprenticeship has successfully been gained.</p> <p>The columns used are any of the following:  Apprenticeship 19P Aims Achievements Funded Only,  Apprenticeship Under 19 Aims Achievements Funded Only,  Community Learning Aims Achievements,  Tailored learning aim achievements,  ET 19P Aims Achievements,  FES 19P Aims Achievements,  FES All Age Aims Achievements</p>
Achievement rate	Achievement rates are based on the individual qualification aims that were completed in the relevant year (Hybrid End Year). They are calculated as the number of aims achieved divided by the number started, excluding the aims of any learners that transferred onto another qualification within the same institution.
Age summary with unknowns Age academic summary with unknowns	<p>This shows the age of the learner as at the 31<sup>st</sup> August of the reported academic year.</p> <p>Age categories (Under 19, 19-24, 25-49, 50+, Unknown)</p>
Age Youth Adult Age Band	<p>This shows the age of the learner as at the 31<sup>st</sup> August of the reported academic year.</p> <p>Age categories (Under 19, 19+)</p>
Age Detailed Age academic detailed	<p>This shows the age of the learner as at the 31<sup>st</sup> August of the reported academic year. This is for use with the FES, CL, TL and ET measures. It also for use with apprenticeship participation measures.</p> <p>Age categories (Under 19, 19-24, 35-44, 45-59, 60+)</p>
Age start detailed	<p>This shows the age of the learner at the start of the programme. This is for use with the apprenticeship enrolments measures.</p> <p>Age categories (Under 19, 19-24, 35-44, 45-59, 60+)</p>
Awarding organisation description	The learning aim's awarding organisation name.
Completers (when used in achievement rate calculations)	A count of the number of learning aims that have been completed.
Delivery_Region Delivery_PCON Delivery_LA Delivery_LAD	<p>Geographical breakdown based on the delivery postcode</p> <p>PCON = Parliamentary Constituency</p>

Delivery_Developed_Administration	LA = Local Authority LAD = Local Authority District
Delivery_Region_Code Delivery_PCON_Code Delivery_LA_Code Delivery_LAD_Code Delivery_Developed_Administration_Code	Reference code assigned to the geographical breakdowns based on delivery postcode
Detailed Level or Apps Level Detailed	Level of the apprenticeship (Level 2; 3; 4; 5; 6; 7).
Enrolments	Enrolments indicates that a learner was on a framework or aim during a period.  The columns used are any of the following: Apprenticeship 19P Aims Enrolments Funded Only, Apprenticeship Under 19 Aims Enrolments Funded Only, Community Learning Aims Enrolments, Tailored Learning Aims Enrolments, ET 19P Aims Enrolments, FES 19P Aims Enrolments, FES All Age Aims Enrolments
Ethnicity	Learners ethnicity (i.e. the self-declared ethnicity from which the Ethnicity group is derived).
Ethnicity major	The self-declared ethnicity group of the learner (Asian/Asian British; Black/African/Caribbean/Black British; Mixed/Multiple Ethnic Group; Not App/Known; Other Ethnic Group; White; Totals).
Ethnicity minor	African, Any other Asian Background, Any other Black/African/Caribbean Background, Any other ethnic group, Any other Mixed/multiple ethnic background, Any other White Background, Arab, Bangladeshi, Caribbean, Chinese, English/Welsh/Scottish/Northern Irish/ British, Gypsy or Irish Traveller, Indian, Not Provided, Pakistani, Total, White and Asian, White and Black Caribbean, White and Black African
Essential skills qualification type	Essential skills qualification type is primarily the 'Skills for life type description' recorded on the Learning Aim Reference Service (LARS) with additional types included for non-regulated essential skills aims not present on LARS.
Free Courses for Jobs Valid to/from	Free Courses for Jobs funding approval start and end dates.
Free Courses for Jobs Total Takeup Original Offer	How many learners started a qualification on the original Free Courses for Jobs offer.
Free Courses for Jobs Total Takeup Extended Offer	How many learners started a qualification on Free Courses for Jobs, including the extended offer for unemployed and low-paid workers.
Free Courses for Jobs Total Achievements Original Offer	How many learners achieved a qualification on the original Free Courses for Jobs offer.
Free Courses for Jobs Total Achievements Extended Offer	How many learners achieved a qualification on Free Courses for Jobs, including the extended offer for unemployed and low-paid workers.

Higher technical qualification (HTQ) status	A flag for learning aim's that are a higher technical qualification. Please note the HTQ data in this publication only includes learners recorded via the ILR. There are additional HTQ learners recorded via HESA data.
Learner_Home_Region Learner_Home_PCON Learner_Home_LA Learner_Home_LAD Learner_Home_Devolved_Administration Learner_Home_LEP	Geographical breakdown based on the learner home postcode.  PCON = Parliamentary Constituency LA = Local Authority LAD = Local Authority District CA = Combined Authority LEP = Local Enterprise Partnership
Learner_Home_Region_Code Learner_Home_PCON_Code Learner_Home_LA_Code Learner_Home_LAD_Code Learner_Home_Devolved_Administration_Code Learner_Home_LEP_Code	Reference code assigned to the geographical breakdowns based on learner home postcode
Learning Aim	Learning Aim is a generic term which includes qualifications, courses and learning events under a general title.
Learning Aim Reference	Reference code for a learning aim which corresponds to the ILR
Learning Aim Title	Title of a learning aim
Learning Aim Type	The type of learning aim awarded (e.g. A Level, Diploma, Certificate...)
Leavers (when used in achievement rate calculations)	The total volume of learners included, this is the denominator used in achievement rate calculation.
Level Or App Level	Apprenticeship level (Intermediate, advanced or higher). Or FE and Skills programmes Level (Entry, 1, 2, 3, 4, 5, 6, 7, High Level)
Learner Participation Q1, Q2, Q3, Q4, or Full Year	Learner was in learning at any point during the indicated quarter or any point during the year (full year)
LLDD	Defines if the learner self declares that they are a learner with a learning difficulty and/or disability.
Notional NVQ Level	The Notional NVQ Level indicates the level of a qualification on the NVQ scale or a notional level where an aim has not been assigned a level on the National Qualifications Framework (NQF).  The values used in this classification are:  Level 1 and entry Level 2 Level 3 Level 4, 5 and Higher Education (HE) Level not specified
Participation	Learner was in learning at any point during the year  The column used are any of the following:



	FES All Age, FES_Total19P, ET_19P, CL Participation, Apprenticeships19P, Apprenticeships Under 19
Pass rate	Pass rates are based on the individual aims that were successfully completed in the relevant year (the Hybrid End Year). They are calculated as the number of learning aims achieved divided by the number successfully completed.
Provider, Provider Name	Name of the provider
Provider Type	Indicates the type of organisation General FE and Tertiary College Other Public Funded Private Sector Public Funded Schools Sixth Form College Specialist College
Qualification Reference Number	Reference code for a learning aim which corresponds to the ILR
Qualification Title	Title of Qualification
Qualification Type	Type of Qualification (Occupational, Vocational or Other)
Retention rate	Retention rates are based on the individual aims that were successfully completed in the relevant year (the Hybrid End Year). They are calculated as the number of learning aims completed divided by the number of leavers.
Sex	Sex of the learner.
Short Course	Short courses are those labelled as 'Level three Free Courses short qualification' in the <a href="#">list of qualifications approved for funding</a>
SSA Tier 1	Sector subject area (tier 1) of the apprenticeship standard or framework or learning aim being studied.
SSA Tier 1 Code	Reference code assigned to a Sector subject area (tier 1)
SSA Tier 2	The sector subject area (tier 2) of the apprenticeship standard or framework or learning aim being studied.
SSA Tier 2 Code	Reference code assigned to a Sector subject area (tier 2)
STEM	STEM includes those within the following sector subject tier 1 areas: Construction, Planning and the Built Environment, Engineering and Manufacturing Technologies, Information and Communication Technology, Science and Mathematics.
Snapshot	The Individualised Learner Record snapshot used to produce the data: SN04 covers Aug to Oct, as published in January SN06 covers Aug to Jan, as published in March SN10 covers Aug to Apr, as published in July

	SN14 covers the full finalised academic year, as published in November
UKPRN Or Provider UKPRN	The unique provider reference number as assigned when registered on UKRLP system.
Year	Academic year

## Annex B – quick guide to using the underlying files on EES (EXPLORE EDUCATION STATISTICS)

Navigate to the ‘Explore data and files’ section of this release to find several useful underlying and supporting files for the data on the publication.

The underlying data files and meta data information can be found under the ‘All supporting files’ sections. Once expanded you will see a list of all the files available for you to download and use.

Due to the size of some of these files follow these steps to download and access the data.

Click the data file link you wish to view; this will automatically start a download of the file through your internet browser. Once this step is complete, click the file, or open your downloads folder on your file explorer.

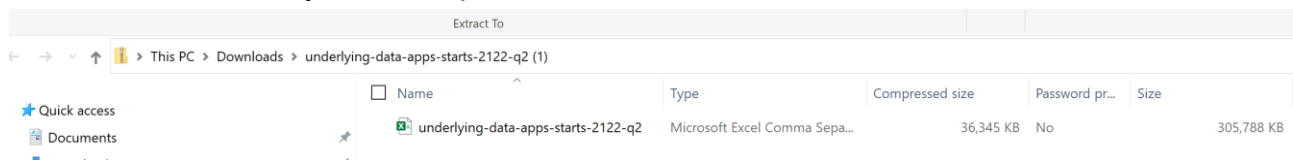

The data files will download as CSV files which you can create a connection to and build a pivot table for your analysis.

Save the file from the downloads folder into a suitable location of your choice.

In excel on the ‘Data’ tab click the ‘From Text/CSV’ button in the top ribbon of Excel.

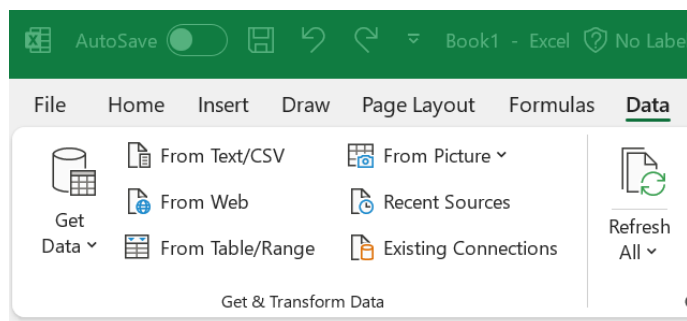

Navigate to the folder the underlying file is saved to and select the file to ‘import’

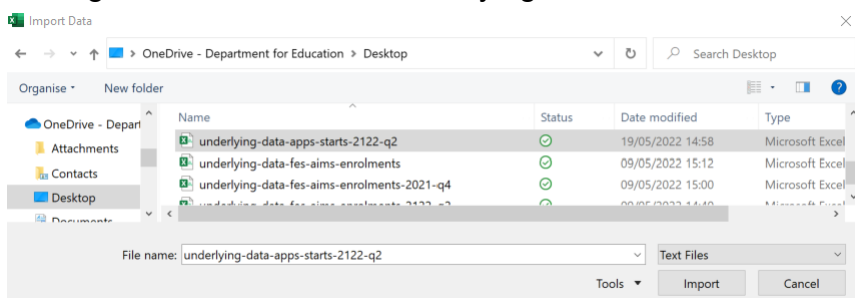

## Select the option to 'Load to'

underlying-data-apps-starts-2122-q2.csv

File Origin: 1252: Western European (Windows) | Delimiter: Comma | Data Type Detection: Based on first 200 rows

year	snapshot	uapm	provider_name	provider_type	delivery_region_code	delivery_region	delivery_pcam_code	delivery_pcam	delivery_la_code	delivery_la	delivery_lad_code	delivery_lad
202122	6	10004772	CITY COLLEGE NORWICH	General FE College Incl Tertiary	E12000006	East of England	E14000864	Norwich South	E10000020	Norfolk	E07000148	Norwich
201920	6	10005599	S & B AUTOMOTIVE ACADEMY LIMITED	Private Sector Public Funded	E12000009	South West	E14000599	Bristol East	E06000023	Bristol	E06000023	Bristol City
202021	6	10005277	SKILLS TO GROUP LIMITED	Private Sector Public Funded	E12000009	South West	E14000950	South West Devon	E06000026	Plymouth	E06000026	Plymouth
201920	6	10011880	P.T.P. TRAINING LIMITED	Private Sector Public Funded	E12000005	West Midlands	E14000568	Birmingham, Yardley	E08000025	Birmingham	E08000025	Birmingham
201920	6	10000712	UNIVERSITY COLLEGE BIRMINGHAM	Other Public Funded (i.e. LA's and HE)	E12000005	West Midlands	E14000812	Meriden	E08000029	Soilhill	E08000029	Soilhill
202021	6	10002852	HALESOWEN COLLEGE	General FE College Incl Tertiary	E12000005	West Midlands	E14000722	Halesowen and Rowley Regis	E08000027	Dudley	E08000027	Dudley
202122	6	10004830	GINGER NUT MEDIA LIMITED	Private Sector Public Funded	E12000005	West Midlands	E14000651	Coventry South	E08000026	Coventry	E08000026	Coventry
202021	6	10001000	BURNLEY COLLEGE	General FE College Incl Tertiary	E12000002	North West	E14000609	Burnley	E10000017	Lancashire	E07000117	Burnley
202122	6	10023047	REMIT GROUP LIMITED	Private Sector Public Funded	E12000005	West Midlands	E14001050	Wolverhampton South East	E08000031	Wolverhampton	E08000031	Wolverhampton
202122	6	10001696	CORNWALL COLLEGE	General FE College Incl Tertiary	E12000009	South West	E14000616	Camborne and Redruth	E06000052	Cornwall (Includes Isles of Scilly)	E06000052	Cornwall
202122	6	10000446	KAPLAN FINANCIAL LIMITED	Private Sector Public Funded	E12000007	London	E14000953	Bermondsey and Old Southwark	E09000028	Southwark	E09000028	Southwark
202122	6	10007063	KAPLAN FINANCIAL LIMITED	General FE College Incl Tertiary	E12000009	South West	E14001003	Truro and Falmouth	E06000052	Cornwall (Includes Isles of Scilly)	E06000052	Cornwall
201920	6	10004844	MIDDLEBROUGH COLLEGE	General FE College Incl Tertiary	E12000001	North East	E14000819	Middlesbrough	E06000002	Middlesbrough	E06000002	Middlesbrough
202021	6	10007822	CRANFIELD UNIVERSITY	Other Public Funded (i.e. LA's and HE)	E12000006	East of England	E14000813	Mid Bedfordshire	E06000056	Central Bedfordshire	E06000056	Central Bedfordshire
201920	6	10004552	NELSON AND COLNE COLLEGE	General FE College Incl Tertiary	E12000002	North West	E14000875	Pendle	E10000017	Lancashire	E07000122	Pendle
201920	6	10000421	ASPIRATION TRAINING LIMITED	Private Sector Public Funded	E12000005	West Midlands	E14000847	North Herefordshire	E06000019	Herefordshire	E06000019	Herefordshire
201920	6	10046797	BC ARCH LIMITED	Private Sector Public Funded	E12000005	West Midlands	E14001030	West Bromwich West	E08000028	Sandwell	E08000028	Sandwell
202021	6	10006549	TELFORD COLLEGE	General FE College Incl Tertiary	E12000005	West Midlands	E14000989	Telford	E06000020	Telford and Wrekin	E06000020	Telford and Wrekin
201920	6	10004835	OAKLANDS COLLEGE	General FE College Incl Tertiary	E12000006	East of England	E14000745	Hertsmere	E10000015	Hertfordshire	E07000098	Hertsmere
201920	6	10007481	WEST SUFFOLK COLLEGE	General FE College Incl Tertiary	E12000006	East of England	E14000761	Ipswich	E10000029	Suffolk	E07000202	Ipswich

The data in the preview has been truncated due to size limits.

Load Transform Data Cancel

At the next stage it will open an 'import data' window.

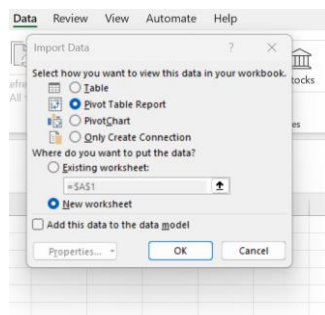

Select 'PivotTable Report'. Whilst the data is loading you will see the queries and connections to the right side of the excel process the pivot table – bigger files can take a while.

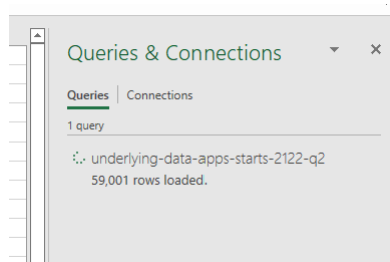

Once this is complete the pivots tables will be ready for you to manipulate in whichever way is required.

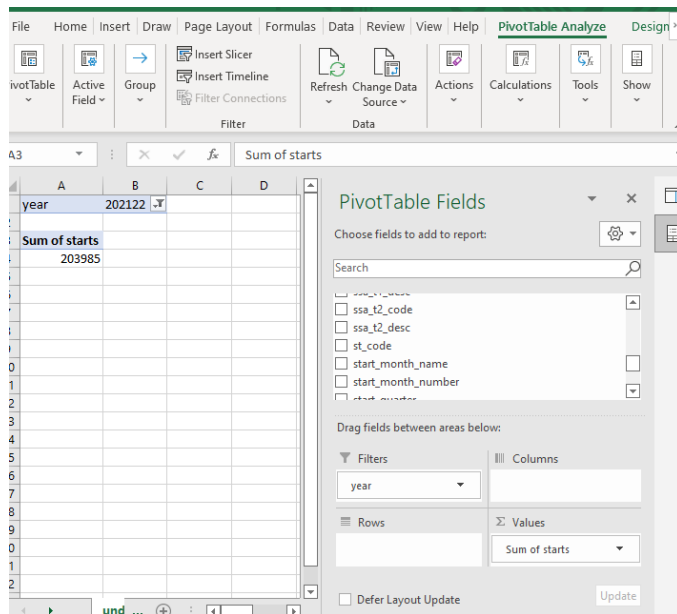

**Top tip!** When creating a pivot table from a large dataset tick 'defer layout update' until you have finished building your pivot options.