

Apprenticeships: January 2026 underlying data

Metadata specification

Description

This document describes the additional supporting files that accompany the 'Apprenticeships: January 2026' accredited official statistics publication. This data is released under the terms of the [Open Government License](#). It is provided to allow users to interrogate the data themselves.

The underlying data files contain apprenticeship starts, achievements and participation figures in England; broken down by learner characteristics (e.g. age, sex, ethnicity group), geography (e.g. region, local authority district) and subject characteristics (e.g. sector subject area, level, framework/standard name).

The [Further education and skills statistics: methodology](#) document published alongside the main release should be referenced alongside this data. It provides information on the data sources, their coverage and quality as well as explaining methodology used in producing the data.

Annex A - Field Listing

Annex B – How to use Excel to connect to larger underlying files for your analysis

The underlying data consists of the following files:

- Underlying data - apprenticeship starts
- Underlying data - apprenticeship achievements
- Underlying data - apprenticeship participation
- Underlying data - apprenticeship demographics
- Underlying data - apprenticeship monthly starts
- Underlying data - apprenticeship vacancies
- Underlying data - starts arising from transferred commitments
- Underlying data - apprenticeship enrolments
- Apprenticeship Achievement Rates - by provider with provider type
- Apprenticeship Achievement Rates - transparency redactions
- Geography Region - starts, achievements, participation, population by age, level (2023 LSIP)

Filename and description	Geographic levels	Time period
Underlying data - apprenticeship starts <i>apps_u01_underlying_starts_202526_4.csv</i> academic_year: Academic year snapshot: Snapshot ukprn: Provider UKPRN provider_name: Provider name provider_type: Provider type provider_type_detailed_code: Detailed Provider type code provider_type_detailed: Provider type detailed delivery_region_code: Learner region code (based on delivery postcode) delivery_region: Learner region description (based on delivery postcode) delivery_pcon_code: Learner parliamentary constituency code (based on delivery postcode) delivery_pcon: Learner parliamentary constituency description (based on delivery postcode) delivery_la_code: Learner local authority code (based on delivery postcode) delivery_la: Learner local authority description (based on delivery postcode) delivery_lad_code: Learner local authority district code (based on delivery postcode) delivery_lad: Learner local authority district description (based on delivery postcode) delivery_devolved_administration_code: Learner English devolved area code (based on delivery postcode) delivery_devolved_administration: Learner English devolved area description (based on delivery postcode) learner_home_region_code: Learner region code (based on home postcode) learner_home_region: Learner region description (based on home postcode) learner_home_pcon_code: Learner parliamentary constituency code (based on home postcode) learner_home_pcon: Learner parliamentary constituency description (based on home postcode) learner_home_la_code: Learner local authority code (based on home postcode) learner_home_la: Learner local authority description (based on home postcode) learner_home_lad_code: Learner local authority district code (based on home postcode) learner_home_lad: Learner local authority district description (based on home postcode)	National, region, local authority, local authority district, parliamentary constituency, English devolved administration	2020/21 (full year) 2021/22 (full year) 2022/23 (full year) 2023/24 (full year) 2024/25 (full year) 2025/26 (Aug-Oct)

<p>learner_home_devolved_administration_code: Learner English devolved area code (based on home postcode)</p> <p>learner_home_devolved_administration: Learner English devolved area description (based on home postcode)</p> <p>age_summary: Age group (Under 19, 19-24, 25+)</p> <p>age_youth_adult: Age group (Under 19, 19+)</p> <p>apps_level_6plus: Level 6 or level 7 flag</p> <p>apps_level: Apprenticeship level</p> <p>apps_level_detailed: Detailed apprenticeship level</p> <p>ssa_tier_1_code: Sector subject area Tier 1 code</p> <p>ssa_tier_1: Sector subject area Tier 1 description</p> <p>ssa_tier_2_code: Sector subject area Tier 2 code</p> <p>ssa_tier_2: Sector subject area Tier 2 description</p> <p>stem: STEM flag</p> <p>std_fwkw_flag: Whether the apprenticeship is a standard or framework</p> <p>apprenticeship_type: Foundation apprenticeship flag</p> <p>std_fwkw_name: Standard or framework name</p> <p>std_fwkw_code: Standard or framework reference code assigned to a framework/standard, to be used in conjunction with the framework/standard flag. This is made up of: For standards – the LARS standard code. For frameworks – the SASE code.</p> <p>st_code: Standard code from the Skills England Search the Apprenticeships tool</p> <p>route: Route</p> <p>apps_mandatory_degree: Mandatory degree flag</p> <p>start_quarter: Academic quarter in which the apprenticeship programme started</p> <p>start_month_number: Month number in academic in year in which the apprenticeship programme started</p> <p>start_month: Month in which the apprenticeship programme started</p> <p>length_employment: Length of employment at the point at which the apprenticeship was started</p> <p>funding_type: Flag showing whether the apprenticeship is funded by ASA levy funds</p> <p>flexijob: Flexi-Job Agency apprenticeship starts. For more information see the Flexi-job apprenticeships using an approved agency guidance.</p> <p>starts: Number of apprenticeship starts</p>		
---	--	--

<p>Underlying data - apprenticeship achievements <i>apps_u03_underlying_achievements_202526_4.csv</i></p> <p>academic_year: Academic year</p> <p>snapshot: Snapshot</p> <p>ukprn: Provider UKPRN</p> <p>provider_name: Provider name</p> <p>provider_type: Provider type</p> <p>delivery_region_code: Learner region code (based on delivery postcode)</p> <p>delivery_region: Learner region description (based on delivery postcode)</p> <p>delivery_pcon_code: Learner parliamentary constituency code (based on delivery postcode)</p> <p>delivery_pcon: Learner parliamentary constituency description (based on delivery postcode)</p> <p>delivery_la_code: Learner local authority code (based on delivery postcode)</p> <p>delivery_la: Learner local authority description (based on delivery postcode)</p> <p>delivery_lad_code: Learner local authority district code (based on delivery postcode)</p> <p>delivery_lad: Learner local authority district description (based on delivery postcode)</p> <p>delivery_devolved_administration_code: Learner English devolved area code (based on delivery postcode)</p> <p>delivery_devolved_administration: Learner English devolved area description (based on delivery postcode)</p> <p>learner_home_region_code: Learner region code (based on home postcode)</p> <p>learner_home_region: Learner region description (based on home postcode)</p> <p>learner_home_pcon_code: Learner parliamentary constituency code (based on home postcode)</p> <p>learner_home_pcon: Learner parliamentary constituency description (based on home postcode)</p> <p>learner_home_la_code: Learner local authority code (based on home postcode)</p> <p>learner_home_la: Learner local authority description (based on home postcode)</p> <p>learner_home_lad_code: Learner local authority district code (based on home postcode)</p> <p>learner_home_lad: Learner local authority district description (based on home postcode)</p> <p>learner_home_devolved_administration_code: Learner English devolved area code (based on home postcode)</p> <p>learner_home_devolved_administration: Learner English devolved area description (based on home postcode)</p>	<p>National, region, local authority, local authority district, parliamentary constituency, English devolved administration</p>	<p>2020/21 (full year)</p> <p>2021/22 (full year)</p> <p>2022/23 (full year)</p> <p>2023/24 (full year)</p> <p>2024/25 (full year)</p> <p>2025/26 (Aug-Oct)</p>
---	---	---

<p>age_summary: Age group (Under 19, 19-24, 25+)</p> <p>age_youth_adult: Age group (Under 19, 19+)</p> <p>apps_level_6plus: Level 6 or level 7 flag</p> <p>apps_level: Apprenticeship level</p> <p>apps_level_detailed: Detailed apprenticeship level</p> <p>ssa_tier_1_code: Sector subject area Tier 1 code</p> <p>ssa_tier_1: Sector subject area Tier 1 description</p> <p>ssa_tier_2_code: Sector subject area Tier 2 code</p> <p>ssa_tier_2: Sector subject area Tier 2 description</p> <p>stem: STEM flag</p> <p>std_fwkw_flag: Whether the apprenticeship is a standard or framework</p> <p>std_fwkw_name: Standard or framework name</p> <p>std_fwkw_code: Standard or framework reference code assigned to a framework/standard, to be used in conjunction with the framework/standard flag. This is made up of: For standards – the LARS standard code. For frameworks – the SASE code.</p> <p>st_code: Standard code from the Skills England Search the Apprenticeships tool</p> <p>route: Route</p> <p>apps_mandatory_degree: Mandatory degree flag</p> <p>leave_month_number: Academic month number in year in which the apprenticeship programme was achieved</p> <p>leave_month: Academic month in which the apprenticeship programme was achieved</p> <p>leave_quarter: Academic quarter in which the apprenticeship was achieved</p> <p>length_employment: Length of employment at the point at which the apprenticeship was started</p> <p>funding_type: Flag showing whether the apprenticeship is funded by ASA levy funds</p> <p>flexijob: Flexi-Job Agency apprenticeship achievements. For more information see the Flexi-job apprenticeships using an approved agency guidance.</p> <p>achievements: Number of apprenticeship achievements</p>		
--	--	--

Filename and description	Geographic levels	Time period
Underlying data - apprenticeship enrolments <i>apps_u05_underlying_enrolments_202526_4.csv</i> academic_year: Academic year snapshot: Snapshot ukprn: Provider UKPRN provider_name: Provider name provider_type: Provider type delivery_region_code: Learner region code (based on delivery postcode) delivery_region: Learner region description (based on delivery postcode) delivery_pcon_code: Learner parliamentary constituency code (based on delivery postcode) delivery_pcon: Learner parliamentary constituency description (based on delivery postcode) delivery_la_code: Learner local authority code (based on delivery postcode) delivery_la: Learner local authority description (based on delivery postcode) delivery_lad_code: Learner local authority district code (based on delivery postcode) delivery_lad: Learner local authority district description (based on delivery postcode) delivery_devolved_administration_code: Learner English devolved area code (based on delivery postcode) delivery_devolved_administration: Learner English devolved area description (based on delivery postcode) learner_home_region_code: Learner region code (based on home postcode) learner_home_region: Learner region description (based on home postcode) learner_home_pcon_code: Learner parliamentary constituency code (based on home postcode) learner_home_pcon: Learner parliamentary constituency description (based on home postcode) learner_home_la_code: Learner local authority code (based on home postcode) learner_home_la: Learner local authority description (based on home postcode) learner_home_lad_code: Learner local authority district code (based on home postcode) learner_home_lad: Learner local authority district description (based on home postcode) learner_home_devolved_administration_code: Learner English devolved area code (based on home postcode)	National, region, local authority, local authority district, parliamentary constituency, English devolved administration	2020/21 (full year) 2021/22 (full year) 2022/23 (full year) 2023/24 (full year) 2024/25 (full year) 2025/26 (Aug-Oct)

<p>learner_home_devolved_administration: Learner English devolved area description (based on home postcode)</p> <p>age_summary: Age group (Under 19, 19-24, 25+)</p> <p>age_youth_adult: Age group (Under 19, 19+)</p> <p>apps_level_6plus: Level 6 or level 7 flag</p> <p>apps_level: Apprenticeship level</p> <p>apps_level_detailed: Detailed apprenticeship level</p> <p>ssa_tier_1_code: Sector subject area Tier 1 code</p> <p>ssa_tier_1: Sector subject area Tier 1 description</p> <p>ssa_tier_2_code: Sector subject area Tier 2 code</p> <p>ssa_tier_2: Sector subject area Tier 2 description</p> <p>stem: STEM flag</p> <p>std_fwkw_flag: Whether the apprenticeship is a standard or framework</p> <p>std_fwkw_name: Standard or framework name</p> <p>std_fwkw_code: Standard or framework reference code assigned to a framework/standard, to be used in conjunction with the framework/standard flag. This is made up of: For standards – the LARS standard code. For frameworks – the SASE code.</p> <p>st_code: Standard code from the Skills England Search the Apprenticeships tool</p> <p>route: Route</p> <p>apps_mandatory_degree: Mandatory degree flag</p> <p>length_employment: Length of employment at the point at which the apprenticeship was started</p> <p>funding_type: Flag showing whether the apprenticeship is funded by ASA levy funds</p> <p>enrolments: Number of apprenticeship enrolments</p>		
--	--	--

<p>Underlying data - apprenticeship participation <i>apps_u02_underlying_participation_202526_4.csv</i></p> <p>academic_year: Academic year</p> <p>snapshot: Snapshot</p> <p>ukprn: Provider UKPRN</p> <p>provider_name: Provider name</p> <p>provider_type: Provider type</p> <p>learner_home_region_code: Learner region code (based on home postcode)</p> <p>learner_home_region: Learner region description (based on home postcode)</p> <p>learner_home_pcon_code: Learner parliamentary constituency code (based on home postcode)</p> <p>learner_home_pcon: Learner parliamentary constituency description (based on home postcode)</p> <p>learner_home_la_code: Learner local authority code (based on home postcode)</p> <p>learner_home_la: Learner local authority description (based on home postcode)</p> <p>learner_home_lad_code: Learner local authority district code (based on home postcode)</p> <p>learner_home_lad: Learner local authority district description (based on home postcode)</p> <p>learner_home_devolved_administration_code: Learner English devolved area code (based on home postcode)</p> <p>learner_home_devolved_administration: Learner English devolved area description (based on home postcode)</p> <p>age_summary_with_unknowns: Age group (Under 19, 19-24, 25-49, 50+, Unknown)</p> <p>age_youth_adult: Age group (Under 19, 19+)</p> <p>participation: Number of participating learners</p>	<p>National, region, local authority, local authority district, parliamentary constituency, English devolved administration</p>	<p>2020/21 (full year)</p> <p>2021/22 (full year)</p> <p>2022/23 (full year)</p> <p>2023/24 (full year)</p> <p>2024/25 (full year)</p> <p>2025/26 (Aug-Oct)</p>
--	---	---

<p>Underlying data - apprenticeship demographics</p> <p><i>apps_u04_underlying_data_demographics_202526_4.csv</i></p> <p><i>This csv is rounded and contains pre-calculated totals. Please be aware when using this tool to derive further breakdowns.</i></p> <p>academic_year: Academic year</p> <p>snapshot: Snapshot</p> <p>learner_home_lad: Learner local authority district description (based on home postcode)</p> <p>apps_level: Apprenticeship level</p> <p>age_summary: Age group (Under 19, 19-24, 25+)</p> <p>sex: Sex (self declared)</p> <p>lidd: LLDD status of learner (self declared)</p> <p>ethnicity_major: Ethnicity group of learner (self declared)</p> <p>starts: Number of apprenticeship starts</p> <p>achievements: Number of apprenticeship achievements</p>	<p>National, local authority district</p>	<p>2020/21 (full year)</p> <p>2021/22 (full year)</p> <p>2022/23 (full year)</p> <p>2023/24 (full year)</p> <p>2024/25 (full year)</p> <p>2025/26 (Aug-Oct)</p>
--	---	---

<p>Underlying data - apprenticeship monthly starts</p> <p><i>apps_u10_underlying_monthly_starts_202526_4.csv</i></p> <p>This contains finalised full year data for the 2014/15 to 2024/25 academic years and data, reported to date, covering the 2025/26 academic year (August to October).</p> <p>academic_year: Academic year</p> <p>snapshot: Snapshot</p> <p>start_month: Month in which the apprenticeship programme started</p> <p>start_month_number: Month number in academic year in which the apprenticeship programme started</p> <p>age_summary: Age group (Under 19, 19-24, 25+)</p> <p>apps_level: Apprenticeship level</p> <p>apps_level_detailed: Detailed apprenticeship level</p> <p>std_fwkw_flag: Whether the apprenticeship is a standard or framework</p> <p>ssa_tier_1: Sector subject area Tier 1 description</p> <p>ssa_tier_2: Sector subject area Tier 2 description</p> <p>st_code: Standard code from the Skills England Search the Apprenticeships tool</p> <p>std_fwkw_name: Standard or framework name</p> <p>apps_mandatory_degree: Whether the apprenticeship has a mandatory degree component</p> <p>funding_type: Flag showing whether the apprenticeship is funded by ASA levy funds</p> <p>starts: Number of apprenticeship starts</p>	<p>National</p>	<p>2014/15 (full year)</p> <p>2015/16 (full year)</p> <p>2016/17 (full year)</p> <p>2017/18 (full year)</p> <p>2018/19 (full year)</p> <p>2019/20 (full year)</p> <p>2020/21 (full year)</p> <p>2021/22 (full year)</p> <p>2022/23 (full year)</p> <p>2023/24 (full year)</p> <p>2024/25 (full year)</p> <p>2025/26 (Aug-Oct)</p>
---	-----------------	---

<p>Underlying data – apprenticeship vacancies</p> <p><i>apps_u12_underlying_data_vacancies_202526_4.csv</i></p> <p>This dataset comprises apprenticeship advert and vacancy content supplied by recruiters and published on the Find An Apprenticeship digital service.</p> <p>The service is operated by the Department for Education as a recruitment platform, free at point of use. It enables:</p> <ul style="list-style-type: none"> • Employers to publicise apprenticeship vacancies. • Candidates to apply for vacancies. • Recruiters to manage the recruitment process for the vacancies displayed on the service. <p>A Vacancy is defined as a single opportunity for a unique individual to be employed as an Apprentice. A single advertisement (previously referred to as a Vacancy Notice) may contain one or more Vacancies.</p> <p>The dataset comprises the items listed below. All standard fields are populated using a standardised selection of data items, some are automatically system-populated. The content of free text fields is drafted by the author of an advertisement and is not restricted by the system. Please note that any apprenticeships arising as a result of the vacancy must comply with apprenticeship funding rules.</p> <p>vacancy_reference_number (Standard field) System Alphanumeric 12-digit UID for each advertisement.</p> <p>current_status (Standard field) Vacancy post status at the time of data extraction (e.g. Live, Deleted, Closed, Complete)</p> <p>date_posted (Standard field) The date of publishing the vacancy/vacancies.</p> <p>vacancy_title (Free Text field) The employer's chosen descriptor for the vacancy/vacancies advertised.</p> <p>vacancy_description (Free Text field) A summary of the apprenticeship content and working environment.</p> <p>skills_required (Free Text field) The employer's summary of desirable soft and technical skills that would be advantageous to an applicant.</p> <p>qualifications_required (Free Text field) The minimum formal qualifications the employer requires applicants to achieve before they start the apprenticeship.</p> <p>number_of_positions (Standard field) A count of the number of individuals the employer wishes to recruit.</p> <p>application_closing_date (Standard field) The latest date on which applications can be submitted for the vacancy/vacancies listed.</p>	National	Aug 2022 onwards
---	----------	------------------

<p>expected_start_date (Standard field) The date on which a successful applicant should expect to start their apprenticeship.</p> <p>employer_full_name (Free Text field) The full name of the employer offering the vacancy/vacancies.</p> <p>provider_full_name (Free Text field) The full name of the organisation that will provide off-the-job training.</p> <p>vacancy_postcode (Standard field) The postcode of the workplace location where the apprenticeship is based.</p> <p>vacancy_town (Standard field) Town of the apprenticeship workplace location.</p> <p>wage_unit_desc (Standard field) Choice of: Annually; Weekly; Monthly</p> <p>wage (Free Text field) The value in £ to be paid by the employer per wage unit worked.</p> <p>wage_type (Standard field) Choice of: Apprenticeship Minimum Wage; Competitive salary; Custom Wage; Custom Wage Range; Fixed Wage; National Minimum Wage; To be agreed upon appointment</p> <p>hours_per_week (Free Text field) Summary of expected hours to be worked in a 5-day week.</p> <p>expected_duration (Free Text field) Estimated duration between start and completion of the apprenticeship.</p> <p>apprenticeship_type (Standard field) May be any of the following: Advanced Level Apprenticeship Degree Level Apprenticeship Higher Level Apprenticeship Intermediate Level Apprenticeship</p> <p>training_type (Standard field) Identifies whether vacancy learning element is based on apprenticeship standard or framework.</p> <p>framework_or_standard_name (Standard field) Industry-standard unique identifier (UID) for the apprenticeship in an advertisement.</p> <p>sector_name (Standard field) Used to segment Apprenticeships according to economic sector.</p> <p>education_level (Standard field) The education level of the apprenticeship qualification.</p>		
---	--	--

<p>source_db (Standard field)</p> <p>Identifier for the database through which the advertisement is processed. Version 1 (V1) is a legacy system, used predominantly by training providers, recruiting on behalf of employers. Version 2 (V2) is used predominantly by employers accessing the system through their digital accounts with the Apprenticeship Service (AS).</p>		
---	--	--

<p>Underlying data - starts arising from transferred commitments</p> <p><i>apps_u16_underlying_data_service_transfers_202526_4.csv</i></p> <p>Commitments are as reported on the Apprenticeship Service as of 09 December 2025. Apprenticeship starts are based on the SN14 Individualised Learner Record (ILR) returns (2017/18 to 2024/25 full year) and the 2025/26 SN04 return for the 2025/26 academic year (August to October, reported to date).</p> <p>time_identifier: Time unit shown (i.e. academic or calendar year)</p> <p>time_period: Academic year</p> <p>country_code: Country code</p> <p>country_name: Country name</p> <p>learner_home_region_code: Learner region code (based on home postcode)</p> <p>learner_home_region: Learner region description (based on home postcode)</p> <p>learner_home_lad_code: Learner local authority district code (based on home postcode)</p> <p>learner_home_lad: Learner local authority district description (based on home postcode)</p> <p>age_summary: Age group (Under 19, 19-24, 25+)</p> <p>apps_level: Apprenticeship level</p> <p>ssa_tier_1: Sector subject area Tier 1 description</p> <p>latest_levy_status: Latest known levy status of apprenticeship service account holding organisation</p> <p>levy_transfer_matching: Transfer from the Levy Transfer Matching service</p> <p>transferred_starts: Apprenticeship starts arising from transferred commitments</p> <p><i>Commitments may be recorded or revised on the Apprenticeship Service system after the training start date has passed. Data for previous academic years can also be revised as details are updated by employers. This means all data, especially the most recent data, should be treated as provisional as more commitments are recorded on the apprenticeship service system.</i></p>	<p>National, Region, Local authority district</p>	<p>2017/18 (full year)</p> <p>2018/19 (full year)</p> <p>2019/20 (full year)</p> <p>2020/21 (full year)</p> <p>2021/22 (full year)</p> <p>2022/23 (full year)</p> <p>2023/24 (full year)</p> <p>2024/25 (full year)</p> <p>2025/26 (Aug-Oct)</p>
---	---	--

<p>Geography Region - starts, achievements, participation, population by age, level (2023 LSIP)</p> <p><i>app-geography-population-202526-q1-lsip23.csv</i></p> <p>This rounded dataset is based on population estimates from NOMIS using LSIP boundaries as of 2023. The version in the Explore Education Statistics Create your own tables tool is based on the 2025 LSIP boundaries.</p> <p>time_period: Academic year</p> <p>time_identifier: Time unit shown (i.e. academic year)</p> <p>geographic_level: The geography shown (i.e. Local skills improvement plan area)</p> <p>country_code: Country code</p> <p>country_name: Country name</p> <p>lsip_code: Local skills improvement plan area code (based on learner home postcode)</p> <p>lsip_name: Local skills improvement plan area description (based on learner home postcode)</p> <p>apps_level: Apprenticeship level</p> <p>age_summary: Summary age group. For apprenticeship participation this is age as at 31 August of the academic year. For apprenticeship starts and achievements it is age at start of programme.</p> <p>starts: Apprenticeship starts</p> <p>participation: Apprenticeship participation</p> <p>learner_achievements: Apprenticeship achievements</p> <p>population_estimate: population estimates</p> <p>starts_rate_per_100000_population: Apprenticeship starts per 100,000 population</p> <p>participation_rate_per_100000_population: Apprenticeship participation per 100,000 population</p> <p>achievements_rate_per_100000_population: Apprenticeship achievements per 100,000 population</p>	<p>Local skills improvement plan area</p>	<p>2022/23 (full year)</p> <p>2023/24 (full year)</p> <p>2024/25 (full year)</p> <p>2025/26 (Aug-Oct)</p>
--	---	---

<p>Apprenticeship Achievement Rates - by provider with provider type</p> <p><i>apps_narts_provider_level_fwkw_std_with_provider_type.csv</i></p> <p><i>This file contains 2021/22, 2022/23 and 2023/24 achievement rates for individual providers.</i></p> <p>time_period: Academic year</p> <p>time_identifier: Time unit shown (i.e. academic or calendar year)</p> <p>geographic_level: The level of geography the row represents. In this product it is national (England)</p> <p>country_code: Country code</p> <p>country_name: Country name</p> <p>provider_name: Provider name</p> <p>provider_ukprn: Provider UKPRN</p> <p>provider_type: Provider type</p> <p>ssa_tier_1: Sector subject area Tier 1 description</p> <p>level: Apprenticeship level</p> <p>std_fwkw_name_stcode: Standard or framework name and reference code</p> <p>age_youth_adult: Age group (16-18, 19+)</p> <p>age_group: Age group (16-18, 19-23, 24+)</p> <p>leavers: Number of apprenticeship leavers</p> <p>completers: Number of apprenticeship completers</p> <p>achievers: Number of apprenticeship achievers</p> <p>retention_rate: Apprenticeship retention rate</p> <p>pass_rate: Apprenticeship pass rate</p> <p>achievement_rate: Apprenticeship achievement rate</p>	National	<p>2021/22 (hybrid end year)</p> <p>2022/23 (hybrid end year)</p> <p>2023/24 (hybrid end year)</p>
--	----------	--

<p>Apprenticeship Achievement Rates - transparency redactions</p> <p><i>Apprenticeship Achievement Rates - Transparency Redactions.pdf</i></p> <p><i>This file contains Apprenticeship Achievement rates for those providers whose data has been redacted from the official provider level national achievement rate tables.</i></p> <p>Academic Year: Academic year</p> <p>provider_name: Provider name</p> <p>ssa1: Sector subject area Tier 1 description</p> <p>level: Apprenticeship level</p> <p>std_fwkw_name_stcode: Standard or framework name and reference code</p> <p>youth/adult: Age group (16-18, 19+)</p> <p>age group: Age group (16-18, 19-23, 24+)</p> <p>leavers: Number of apprenticeship leavers</p> <p>completers: Number of apprenticeship completers</p> <p>achievers: Number of apprenticeship achievers</p> <p>retention rate: Apprenticeship retention rate</p> <p>pass rate: Apprenticeship pass rate</p> <p>achievement rate: Apprenticeship achievement rate</p>	National	<p>2021/22 (hybrid end year)</p> <p>2022/23 (hybrid end year)</p> <p>2023/24 (hybrid end year)</p>
---	----------	--

Annex A – Field Listing

Further information about the fields in the underlying files is given below:

Variable name	Variable description
Achievers (when used in achievement rate calculations)	A count of achieved programme aims
Achievement	A qualification or apprenticeship has successfully been gained.
Achievement rate	Achievement rates are based on the individual qualification aims that were completed in the relevant year (Hybrid End Year). They are calculated as the number of aims achieved divided by the number started, excluding the aims of any learners that transferred onto another qualification within the same institution.
AgeAcademic Group AgeAcademic 19P	Age of the learner is as at the 31 st August of the reported academic year.
Age or Age Group or Age Summary	Where apprenticeship starts / achievements are being reported, this shows the age of the apprentice at the start of the apprenticeship. Where participation is being reported, this shows the age of the learner as at the 31 st August of the reported academic year. Age categories (Under 19, 19-24, 25+) Where apprenticeship achievement rates are being reported, this shows the age at start of the programme. Age categories (16-18, 19-23, 24+)
Age Youth Adult or youth/adult	Where apprenticeship starts / achievements are being reported, this shows the age group of the apprentice at the start of the apprenticeship. Where participation is being reported, this shows the age of the learner as at the 31 st August of the reported academic year. Age categories (Under 19, 19+) Where apprenticeship achievement rates are being reported, this shows the age at start of the programme.(16-18, 19+)
Apps Level	Apprenticeship level (Intermediate, advanced, or higher). Or FE and Skills programmes Level (Entry ,1,2,3,4,5,6,7, High Level)
Apps Level 6Plus	Level of the apprenticeship Level 6 or Level 7.
Apps mandatory degree	Apprenticeship contains a mandatory degree element. This is based on the latest information available at the time of publication in the Skills England Search the apprenticeships tool .
Apprenticeship Type	Flag indicating Foundation and Non-Foundation apprenticeships
Completers (when used in achievement rate calculations)	A count of completed programme aims
Delivery_Region Delivery_PCON Delivery_LA Delivery_LAD Delivery_Devolved_Administration	Geographical breakdown based on the delivery postcode PCON = Parliamentary Constituency LA = Local Authority LAD = Local Authority District
Delivery_Region_Code Delivery_PCON_Code Delivery_LA_Code	Reference code assigned to the geographical breakdowns based on delivery postcode

Delivery_LAD_Code Delivery_Devolved_Administration_Code	
Detailed Level or Apps Level Detailed	Level of the apprenticeship (Level 2; 3; 4; 5; 6; 7).
Ethnicity	Learners ethnicity (i.e. the self-declared ethnicity from which the Ethnicity group is derived).
Ethnicity major	The self-declared ethnicity group of the learner (Asian/Asian British; Black/African/Caribbean/Black British; Mixed/Multiple Ethnic Group; Not App/Known; Other Ethnic Group; White; Totals).
Flexi-Job	Information on apprenticeship learners taking part in the Flexi-Job initiative. See here for more information: Flexi-Job Apprenticeships - GOV.UK
Framework/Standard Name Or Framework/Standard Title	The name of the framework or standard. For standards, this is based on the latest information available at the time of publication in the Skills England Search the apprenticeships tool. Apprenticeship frameworks are grouped and shown based on their SASE (Specification of Apprenticeship Standards for England) description.
Framework/Standard Flag	Defines if the apprenticeship is a standard or framework.
Framework/Standard Code	Reference code assigned to a framework/standard, to be used in conjunction with the framework/standard flag.
Funding Type	Funding source of the apprenticeship (supported by ASA levy funds; Other; Totals).
Learner_Home_Region Learner_Home_PCON Learner_Home_LA Learner_Home_LAD Learner_Home_Devolved_Administration	Geographical breakdown based on the learner home postcode. PCON = Parliamentary Constituency LA = Local Authority LAD = Local Authority District
Learner_Home_Region_Code Learner_Home_PCON_Code Learner_Home_LA_Code Learner_Home_LAD_Code Learner_Home_Devolved_Administration_Code Learner_Home_LEP_Code	Reference code assigned to the geographical breakdowns based on learner home postcode
Level Or App Level	Apprenticeship level (Intermediate, advanced, or higher). Or FE and Skills programmes Level (Entry ,1,2,3,4,5,6,7, High Level)
Learner Participation Q1, Q2, Q3, Q4, or Full Year	Learner was in learning at any point during the indicated quarter or any point during the year (Full year)
Leave quarter	Academic year quarter in which a learner achieved their apprenticeship programme. Q1 = August-October, Q2 = November-January, Q3 = February-April, Q4 = May-July
Leavers (when used in achievement rate calculations)	The total volume of learners included. This is the denominator used in achievement rate calculation.
Length of Employment	Number of months that an apprentice was employed before commencing an apprenticeship. Banded 0-3mths, 4-6, 7-12, 12+ months
LLDD	Defines if the learner self declares that they are a learner with a learning difficulty and/or disability.
Participation	Learner was in learning at any point during the year
Pass rate	Pass rates are based on the individual aims that were successfully completed in the relevant year (the Hybrid End

	Year). They are calculated as the number of learning aims achieved divided by the number successfully completed.
Provider Provider Name	Name of the provider
Provider Type	Indicates the type of organisation General FE and Tertiary College Other Local Authority Private Sector Public Funded Schools Sixth Form College Specialist College
Provider Type Detailed	More detailed provider type descriptions than the standard provider type breakdowns.
qtr1_learners qtr2_learners qtr3_learners qtr4_learners	Learner was in learning at any point during the indicated quarter or any point during the year (Full year)
Retention rate	Retention rates are based on the individual aims that were successfully completed in the relevant year (the Hybrid End Year). They are calculated as the number of learning aims completed divided by the number of leavers.
Route	The route that the apprenticeship standard is grouped within. This is based on the latest information available at the time of publication in the Skills England Search the apprenticeships tool.
Sex	Sex of the apprentice.
Start	A learner has begun an apprenticeship programme.
Start Month	Month in which a learner began an apprenticeship programme.
Start Quarter	Academic year quarter in which a learner began an apprenticeship programme. Q1 = August-October, Q2 = November-January, Q3 = February-April, Q4 = May-July
SSA Tier 1 or SSA1	Sector subject area (tier 1) of the apprenticeship standard or framework or learning aim being studied.
SSA Tier 1 Code	Reference code assigned to a Sector subject area (tier 1)
SSA Tier 2	The sector subject area (tier 2) of the apprenticeship standard or framework or learning aim being studied.
SSA Tier 2 Code	Reference code assigned to a Sector subject area (tier 2)
STEM	STEM includes those within the following sector subject tier 1 areas: Construction, Planning and the Built Environment, Engineering and Manufacturing Technologies, Information and Communication Technology, Science and Mathematics.
Snapshot	The Individualised Learner Record snapshot used to produce the data: SN04 covers Aug to Oct, as published in January SN06 covers Aug to Jan, as published in March SN10 covers Aug to Apr, as published in July SN14 covers the full finalised academic year, as published in November

ST Code	Apprenticeship standard reference code. This is based on the latest information available in the Skills England Search the apprenticeships tool.
UKPRN or provider UKPRN	The unique provider reference number as assigned when registered on UKRLP system.

Annex B – quick guide to using the underlying files on Explore Education Statistics

Navigate to the 'Explore data and files' section of the release to find several useful underlying and supporting files for the data on the publication.

The underlying data files and metadata specification can be found under the 'All supporting files' sections. Once expanded you will see a list of all the files available for you to download and use.

Due to the size of some of these files follow these steps to download and access the data.

Click the data file link you wish to view; this will automatically start a download of the file through your internet browser. Once this step is complete, click the file, or open your downloads folder on your file explorer.

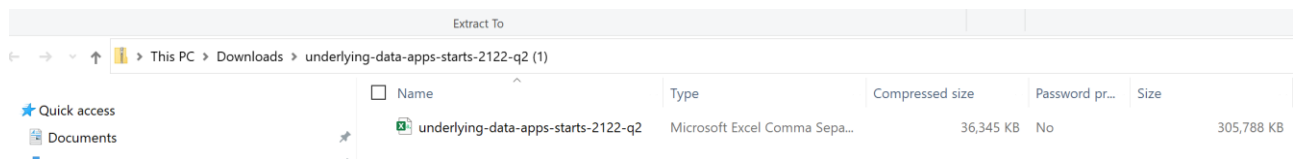

The data files will download as CSV files which you can create a connection to and build a pivot table for your analysis.

Save the file from the downloads folder into a suitable location of your choice.

In excel on the 'Data' tab click the 'From Text/CSV' button in the top ribbon of excel.

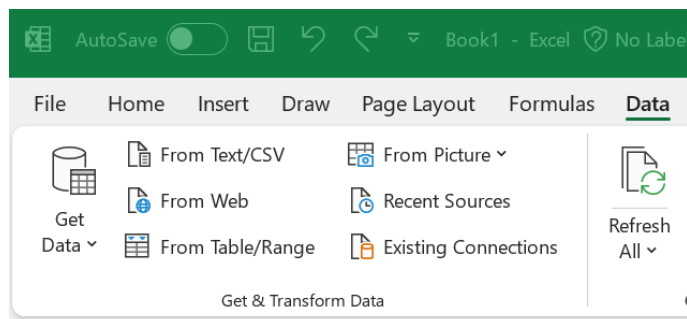

Navigate to the folder the underlying file is saved to and select the file to 'import'

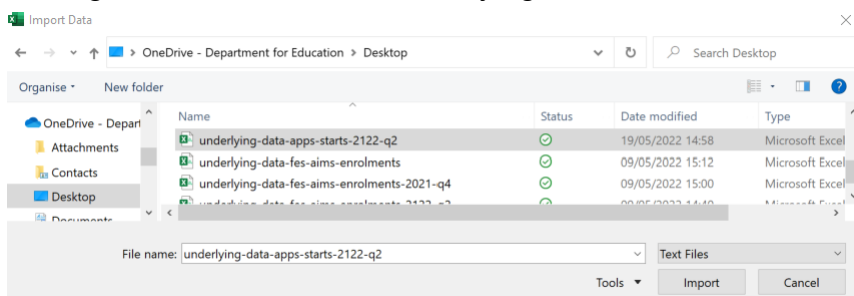

Select the option to 'Load to'

underlying-data-apps-starts-2122-q2.csv

File Origin: 1252: Western European (Windows) | Delimiter: Comma | Data Type Detection: Based on first 200 rows

year	snapshot	uqrm	provider_name	provider_type	delivery_region_code	delivery_region	delivery_pcon_code	delivery_pcon	delivery_la_code	delivery_la	delivery_lad_code	delivery_lad
202122	6	10004772	CITY COLLEGE NORWICH	General FE College Incl Tertiary	E12000006	East of England	E14000864	Norwich South	E10000020	Norfolk	E07000148	Norwich
201920	6	10005599	S & B AUTOMOTIVE ACADEMY LIMITED	Private Sector Public Funded	E12000009	South West	E14000599	Bristol East	E06000023	Bristol	E06000023	Bristol, City
202021	6	10005277	SKILLS TO GROUP LIMITED	Private Sector Public Funded	E12000009	South West	E14000950	South West Devon	E06000026	Plymouth	E06000026	Plymouth
201920	6	10011880	P.T.P. TRAINING LIMITED	Private Sector Public Funded	E12000005	West Midlands	E14000568	Birmingham, Yardley	E08000025	Birmingham	E08000025	Birmingham
201920	6	10000712	UNIVERSITY COLLEGE BIRMINGHAM	Other Public Funded Le LA's and HE	E12000005	West Midlands	E14000812	Meriden	E08000029	Solihull	E08000029	Solihull
202021	6	10002852	HALESOWEN COLLEGE	General FE College Incl Tertiary	E12000005	West Midlands	E14000722	Halesowen and Rowley Regis	E08000027	Dudley	E08000027	Dudley
202122	6	10048380	GINGER NUT MEDIA LIMITED	Private Sector Public Funded	E12000005	West Midlands	E14000651	Coventry South	E08000026	Coventry	E08000026	Coventry
202021	6	10001000	BURNLEY COLLEGE	General FE College Incl Tertiary	E12000002	North West	E14000609	Burnley	E10000017	Lancashire	E07000117	Burnley
202122	6	10023047	REMIT GROUP LIMITED	Private Sector Public Funded	E12000005	West Midlands	E14001050	Wolverhampton South East	E08000031	Wolverhampton	E08000031	Wolverhampton
202122	6	10001696	CORNWALL COLLEGE	General FE College Incl Tertiary	E12000009	South West	E14000616	Camborne and Redruth	E06000052	Cornwall (includes Isles of Scilly)	E06000052	Cornwall
202122	6	10000946	KAPLAN FINANCIAL LIMITED	Private Sector Public Funded	E120000007	London	E14000953	Bermundsey and Old Southwark	E09000028	Southwark	E09000028	Southwark
202122	6	10007063	TRURO AND PENWITH COLLEGE	General FE College Incl Tertiary	E12000009	South West	E14001003	Truro and Falmouth	E06000052	Cornwall (includes Isles of Scilly)	E06000052	Cornwall
201920	6	10004944	MIDDLESBROUGH COLLEGE	General FE College Incl Tertiary	E12000001	North East	E14000819	Middlesbrough	E06000002	Middlesbrough	E06000002	Middlesbrough
202021	6	10007822	CRANFIELD UNIVERSITY	Other Public Funded Le LA's and HE	E12000006	East of England	E14000813	Mid Bedfordshire	E06000056	Central Bedfordshire	E06000056	Central Bedfordshire
201920	6	10004552	NELSON AND COLNE COLLEGE	General FE College Incl Tertiary	E12000002	North West	E14000875	Pendle	E10000017	Lancashire	E07000122	Pendle
201920	6	10000921	ASPIRATION TRAINING LIMITED	Private Sector Public Funded	E12000005	West Midlands	E14000847	North Herefordshire	E06000019	Herefordshire	E06000019	Herefordshire
201920	6	10046797	BC ARCH LIMITED	Private Sector Public Funded	E12000005	West Midlands	E14001030	West Bromwich West	E08000028	Sandwell	E08000028	Sandwell
202021	6	10006549	TELFORD COLLEGE	General FE College Incl Tertiary	E12000005	West Midlands	E14000989	Telford	E06000020	Telford and Wrekin	E06000020	Telford and Wrekin
201920	6	10004835	OAKLANDS COLLEGE	General FE College Incl Tertiary	E12000006	East of England	E14000745	Hertsmere	E10000015	Hertfordshire	E07000098	Hertsmere
201920	6	10007431	WEST SUFFOLK COLLEGE	General FE College Incl Tertiary	E12000006	East of England	E14000761	Ipswich	E10000029	Suffolk	E07000202	Ipswich

The data in the preview has been truncated due to size limits.

Load Transform Data Cancel

At the next stage it will open an 'import data' window.

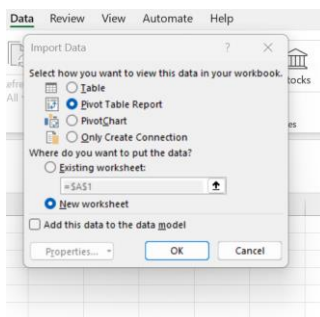

Select 'PivotTable Report'. Whilst the data is loading you will see the queries and connections to the right side of the excel process the pivot table – bigger files can take a while.

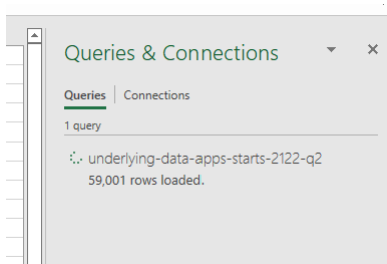

Once this is complete the pivots tables will be ready for you to manipulate in whichever way is required.

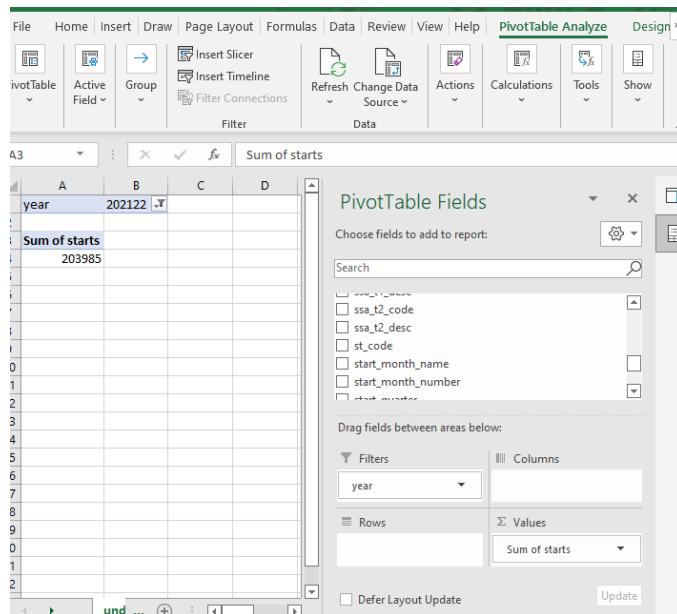

Top tip! When creating a pivot table from a large dataset tick 'defer layout update' until you have finished building your pivot options.